

Jøtul F 118 CB

Woodburning Stove

Addendum to the Installation and Operation Manual cat.no. 220605

Please note the following change in setting up your stove.

Figure 1 on page 5 of the manual incorrectly illustrates the location of the Air Control Limit Bolt which must be removed to operate the air control rod. The bolt location was changed after the manual went to print.

The illustration below shows the correct location of this bolt. Use a 10 mm wrench to remove it from the Air Shutter Plate underneath the back of the stove.

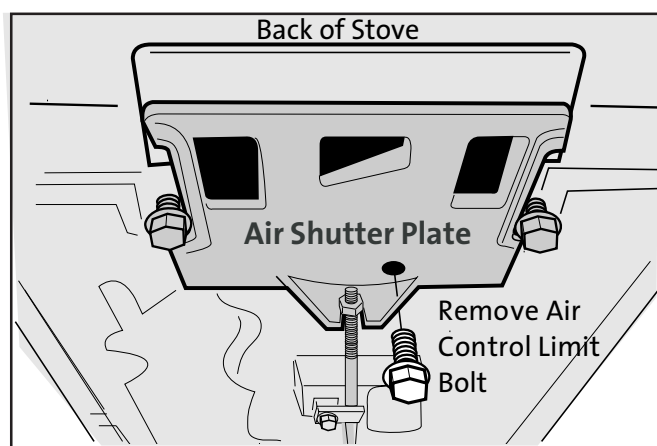

Please keep this Addendum with the manual for future reference.

